

Operating Manual
DELTA SW4 - DPF
Single Seat and Change - Over Valve
with Steam Barrier



Read and understand this manual prior to operating or servicing this product.



Declaration of Conformity for Valves and Valve Manifolds

APV Rosista GmbH, Zechenstr. 49, D-59425 Unna-Königsborn
as manufacturer with sole responsibility declares that the

**double seat valves of the series D2, SD4, SDT4, SDM4, SWcip4, DSV,
DA3, DE3, DEU3, DET3, DKR2, DKRT2, DKRH2**
in the nominal diameters DN 25 - 150, 1" - 6" and 1 Sh5 - 6 Sh5

butterfly valves of the series SV1 and SVS 1 F
in the nominal diameters DN 25 - 100, DN 125 - 250 and 1" - 4"

ball cocks of the series KH, KHV
in the nominal diameters DN 15 - 100

**single seat, diaphragm and spring loaded valves of the series
S2, SW4, SWmini4, SWT4, M3, MF3, M4, MF4, MP4, MS4, AP1, APT1, CPV, RG4,
RGM4, RGE4, RGEM4, PR2, PR3, PR4, SI2, UF3, VRA, VRAH**
in the nominal diameters DN 10 - 150, 1/2" - 4" and 1 Sh5 - 6 Sh5

and the valve manifolds installed thereof

meet the requirements of the Directives 89/392/EEC (amendment 93/44/EEC),
replaced by 98/37/EC and GSG - 9.GSGV.

For official inspections, APV Rosista GmbH presents
a technical documentation according to appendix V of the Machinery Directive,
this documentation consisting of documents of the development and construction,
description of measures taken to meet the conformity and to correspond with
the basic requirements on safety and health, incl. an analysis of the remaining risks
as well as an operating manual with safety instructions.

The conformity of the valves and valve manifolds is guaranteed.

D-59425 Unna-Königsborn, June 04, 2008
APV Rosista GmbH



Manager Research and Development

Table of Content	Page
1. General Terms	2
2. Safety Instructions	2
3. Mode of Operation	3
4. Auxiliary Equipment	4
5. Installation	5
5.1 Welding Instructions	5
6. Dimensions / Weights	6
7. Technical Data	7 - 8
8. Maintenance	9
9. Service Instructions for Single Seat Valves	10 -12
10. Service Instructions for Change-Over Valves	13 - 15
11. Maintenance of Actuator	16
12. Reconstruction of Actuator	17
13. Assembly Tool for Seat Seal	18
14. Trouble Shooting	19
15. Spare Parts Lists	
Single seat valves	
SW 41, SW 42, SWE 41, SWE 42, SWE 43, SWE 44	
DN - RN 01.054.811	Inch - RN 01.054.812
Change - Over valves	
SW 43, SW 44	
DN - RN 01.054.813	Inch - RN 01.054.814
Actuator	RN 01.054.86

1. General Terms

This operating manual should be read carefully by the competent operating and maintenance personnel.

We point out that we will not accept any liability for damage or malfunctions resulting from the non-compliance with this operating manual.

Descriptions and data given herein are subject to technical changes.

2. Safety Instructions

- DANGER!



- The technical safety symbol draws your attention to important directions for operating safety. You will find it wherever the activities described are bearing risks of personal injury.

- Before any maintenance work, the line system must be depressurized and fluid residues must be discharged.

- Disconnect electric and pneumatic lines.

- During sterilisation, the valve is operated with crawl steam.

Attention: Risk of injury by burning.



- Separate steam connections.

- **Do not reach into the open valve.**

- Risk of injury by suddenly operating valve. In dismantled state there is the risk of bruising at movable parts of the valve.

- Observe service instructions to ensure safe maintenance of the valve.

- **Attention! Valve design NC (normally closed): Before releasing the housing clamp connection, the valve insert must be relieved via the controlled actuator.**

- The welded actuator is under spring load, do not open it.

3. Mode of Operation

single seat valve SW4-DPF

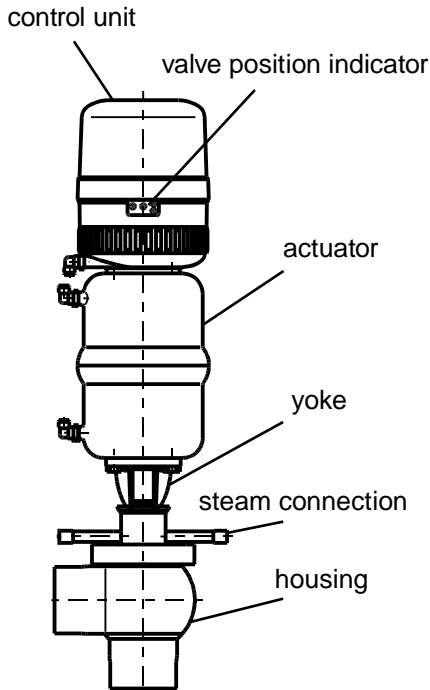

Single seat and change-over valves DELTA SW4 have been developed for applications in the brewing and beverage, dairy and food industries as well as for chemical and pharmaceutical use.

The valves are designed for universal applications and stand out for their increased mechanical reliability and absolute ease of handling.

The function of the DELTA SW4 - DPF valve is to shut off and to change over line sections in sterile processes.

- Operation by pneumatic actuator with air connection, reset by spring force.
- By different assembly of the actuator, the following designs are possible:

NC = normally closed / air-to-raise, spring-to-lower ("fail-down")

NO = normally open / air-to-lower, spring-to-raise ("fail-up")

- The inner parts of the actuator need not be serviced.
- The steam chamber is supplied with crawl steam during the process. A transfer of germs into the product-wetted area is prevented.
- The cleaning of the inner valve is undertaken during CIP cleaning of the line system.
- For the pneumatic control of the valve, the standard design is equipped with a Control Unit DELTA CU 31 on top of the actuator.
- The yellow luminous diodes in the Control Unit indicate the position of the valve shaft.

change - over valve SW4-DPF

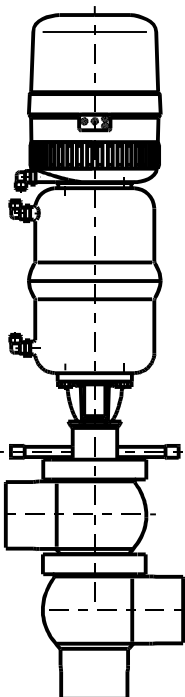

4. Auxiliary Equipment

**PSH
valve position indicator**

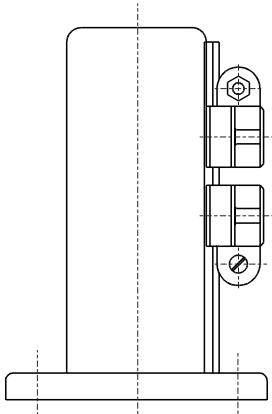

- The actuator can be equipped with a proximity switch holder (PSH) to indicate the valve position. Proximity switches to signal the limit position of the valve seat can be mounted to the support if required.

We recommend our APV standard types:

operating distance: 5 mm / diameter: 11 mm.

If the user decides to apply a valve feedback other than APV type, we cannot take over any guarantee for any malfunctions.

- Control Unit

The SW4 valve can be equipped with a Control Unit.

The following different variants are possible:

**control unit
with adapter**

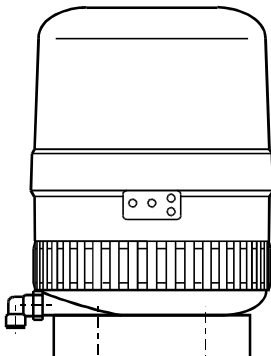

	1 solenoid valve
Direct Connect ref.-No.:	CU31 Direct Connect 322 000 804 629
Profibus ref.-No.:	CU21V 322 000 804 437
Device Net ref.-No.:	CU31 Device Net 322 000 804 611
AS - Interface ref.-No.:	CU31 AS - Interface 322 000 804 701

- An adapter is required to install the Control Unit on the SW4 valve.

adapter	
designation:	CU 2 Adapter - SW4 / SD4 / M4
ref.-No.:	322 000 801 192

5. Installation



- The installation of the valve must be undertaken in such a manner that liquids can drain off the valve housing and should be provided preferably in vertical position.
- The valve housings of single seat valves can be welded direct into the pipeline (valve insert completely dismantlable).
- Through a flange or clamp connection, the upper housing of change-over valves is detachable from the pipeline.
- **Attention:** Observe welding instructions.

5.1 Welding Instructions

Shut-off valve

- Before welding of the valve, the valve insert must be dismantled from the housing. Careful handling to avoid damage to the parts is necessary.

Change-over valve

- Before welding of the valve, the valve insert must be dismantled from the housing. Moreover, remove the lower housing seal. For this purpose, dismantlable connections (flanges, clamps, etc.) must be installed in the pipelines to provide for the disassembly of the two housings and, thus, to have access to the lower seal. Careful handling to avoid damage to the parts is necessary.
- Welding should only be carried out by certified welders (EN 287-1). (Seam quality EN 25817 "B").
- The welding of the valve housings must be undertaken in such a way that the valve body is not deformed.
- The preparation of the weld seam up to 3 mm thickness must be carried out as a square butt joint without air. (Consider shrinkage!)
- TIG orbital welding is best.
- After welding of the valve housings or of the mating flanges and after work at the pipelines, the corresponding parts of the installation or pipelines must be cleaned from welding residues and soiling. If these cleaning instructions are not observed, welding residues and dirt particles can settle in the valve and cause damage.
- Any damage resulting from the non-observance of these welding instructions is not subject to our guarantee.

6. Dimensions / Weights

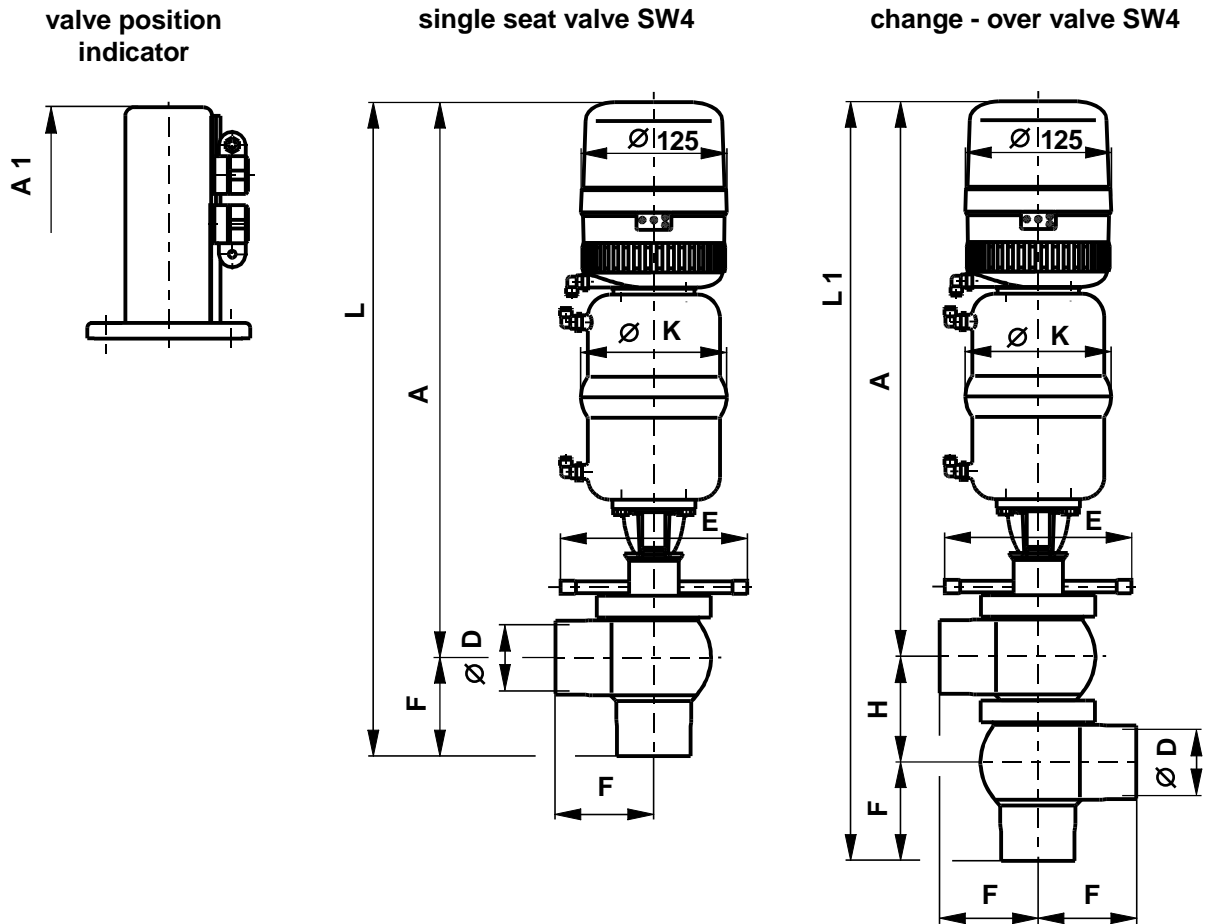

dimensions in mm

DN	A	A1	$\varnothing D$	E	F	H	$\varnothing K$	L	L 1	weights in Kg	
										single seat valve	change - over valve
25	431	371	26	158	50	54	86	481	535	5,2	6,2
40	435	375	38	158	67	66	86	502	568	5,2	6,2
50	472	412	50	158	72	78	126	544	622	7,2	8,2
65	480	420	66	158	85	94	126	565	659	7,2	8,2
80	533	473	81	158	98	109	189	631	740	13,2	15,2
100	543	483	100	158	111	128	189	654	782	15,2	17,2
inch											
1"	429	369	22,2	158	50	50,6	86	479	530	5,2	6,2
1,5"	433	373	34,9	158	67	62,9	86	500	563	5,2	6,2
2"	471	411	47,6	158	72	75,6	126	543	619	7,2	8,2
2,5"	477	417	60,3	158	85	88,3	126	562	650	7,2	8,2
3"	528	468	72,9	158	98	100,9	189	618	719	13,2	15,2
4"	541	481	97,6	158	111	125,6	189	652	778	15,2	17,2

7. Technical Data

product-wetted parts	:	316L, 1.4404
other parts	:	1.4301
seals : standard options		EPDM VMQ, FPM, HNBR
max. operating temperature	:	135 °C EPDM, HNBR *VMQ, *FPM
sterilization temperature (short-term)	:	140 °C EPDM, HNBR *VMQ, *FPM
		* (no steam)
actuators	:	1.4301
air connection (for hose)	:	6x1 mm
max. control air pressure	:	8 bar
min. control air pressure	:	6 bar
(Use dry and clean control air, only!)		
steam chamber: connection		G1/8
max. temperature		130 °C

closing times for SW4 single seat and change-over valves

The opening and closing times of those valves equipped with a control unit can be adjusted by the operator.

stroke in mm

		single seat valve	change - over valve
DN	zoll		
25	1"	12	9
40	1,5"	25	22
50	2"	28	25
65	2,5"	28	25
80	3"	28	25
100	4"	28	25

**closing times in sec.
control pressure 6 bar
hose length 1m and 10m**

		1m	10m
DN	zoll		
25	1"	1	2
40	1,5"	1	2
50	2"	3	4
65	2,5"	3	4
80	3"	5	6
100	4"	5	6

7. Technical Data

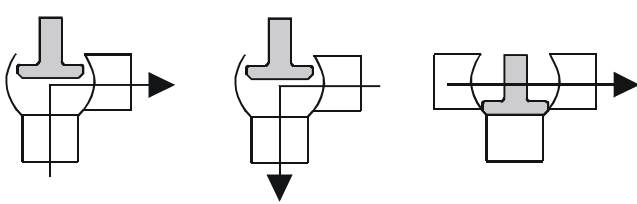
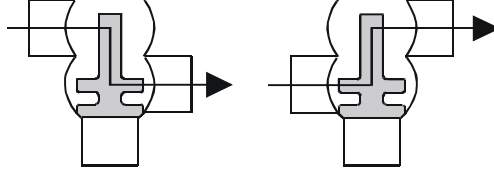
DELTA SW4 Kvs - values in m ³ / h					
	single seat valve			change - over valve	
					
DN					
25	20	21	28	14	13
40	45	53	60	33	31
50	92	85	120	58	51
65	159	159	215	100	89
80	201	209	350	160	137
100	302	325	540	245	212
zoll					
1"	16	18	27	10	10
1,5"	38	45	52	30	28
2"	83	77	118	54	49
2,5"	133	133	200	137	114
3"	176	176	310	137	114
4"	292	310	520	225	210

**DELTA SW4 product pressures in (bar)
at 6 bar control air pressure**

DN	zoll	Ø 74mm actuator		Ø 110mm actuator		Ø 165mm actuator	
		lower seat	upper seat	lower seat	upper seat	lower seat	upper seat
25	1"	14,1	15,8	-	-	-	-
40	1,5"	6,6	7,4	16,8	15,7	-	-
50	2"	2,9	4,3	7,9	9,0	21,1	20,4
65	-	1,9	2,8	5,1	5,9	13,7	13,3
	2,5"	2,8	1,9	5,9	5,1	13,3	13,7
	3"	2,3	1,6	4,9	4,3	11,0	11,4
80	-	1,3	1,9	3,6	4,1	9,6	9,3
100	4"	0,8	1,1	2,1	2,3	5,5	5,3

8. Maintenance

- The maintenance intervals depend on the application of the valve and should be determined by the user carrying out regular checks.
- Tools required:
 - 1 x spanner SW13
 - 1 x spanner SW17
 - 1 x spanner SW19.
- Assembly of the valve and change of the valve design **NC or NO** according to service instructions.
- Change of seals according to service instructions.
Complete seal kits are available.
- **All seals must lightly be greased before their installation!!!**

Recommendation:

APV-food-grade grease for EPDM, FPM, HNBR and NBR

(0,75 kg /can - ref. No. 000 70-01-019/93)

(60 g /tube - ref. No. 000 70-01-018/93)

or

APV-food-grade grease for VMQ (Silicone)

(0,6 kg /can - ref. No. 000 70-01-017/93)

(60 g /tube - ref. No. 000 70-01-016/93)

!!! Do not use grease containing mineral oil for EPDM seals.

!!! Do not use Silicone-based grease for VMQ seals.

9. Service Instructions

valve position indicator

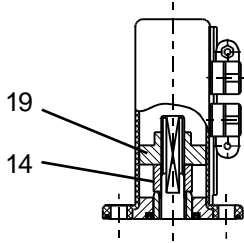

single seat valve

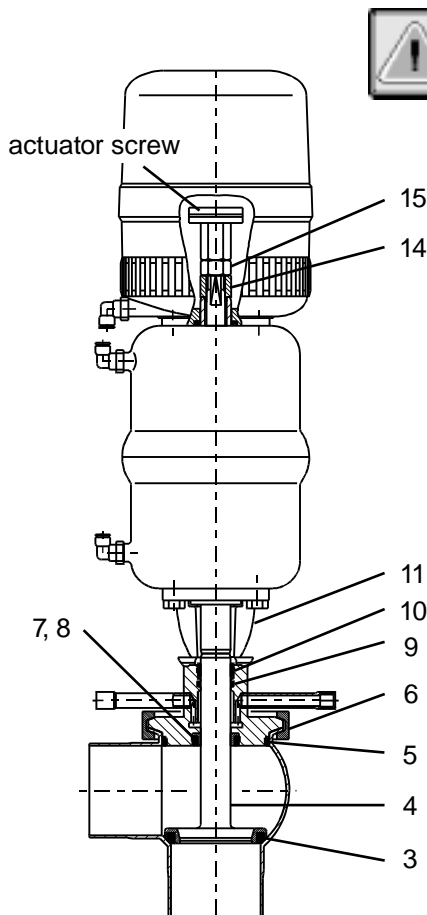

Single seat valves

DELTA SWDPF 41, 42, SWEDPF 41, 42, 43, 44.

The item numbers refer to spare parts list
RN 01.054.811 DN / 01.054.812 Inch

I. Disassembly from the line system

- a. Shut off steam and connecting lines, discharge line pressures and empty lines if possible.
- b. Separate steam connections.
- c. Separate electric and pneumatic connections.
- d. Valve design NC: control actuator with air.

Do not touch movable valve parts!

Risk of injury by sudden valve operation.

- e. Detach clamp (6) and lift valve insert off the housing.
- f. Valve design NC: shut off compressed air.
- g. CU version:
Detach the control unit by turning the locking ring.

Valve position indicator:

Remove proximity switches. Detach indicator housing (proximity switch holder) from actuator.

II. Dismantling of wear parts (product-wetted parts)

- a. Remove housing seal (5).
 - b. CU version:
Unscrew actuator screw, at first. Screw off hexagon nut (15) by holding up the centering washer (14). Remove centering washer.
- Valve position indicator:**
Unscrew metallic actuator screw (19) by holding up the centering washer (14). Remove centering washer.
- c. Pull valve shaft (4) out of the actuator (16). Remove seat seal (3).
 - d. Unscrew yoke (11) from actuator.
 - e. Detach seat seal (7), shaft seal (8), guide bush (10) and O-ring (9).

9. Service Instructions

valve position indicator

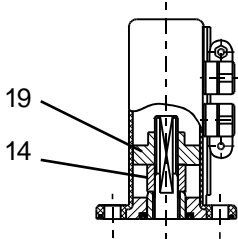

actuator screw

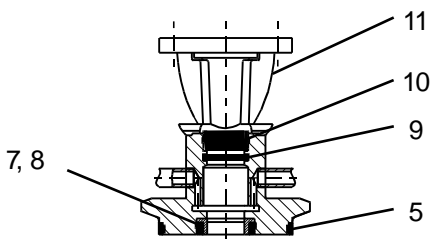
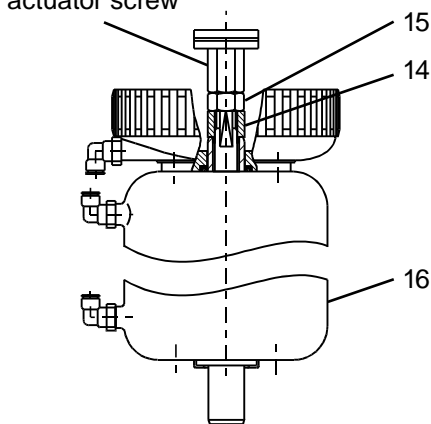

protecting tube

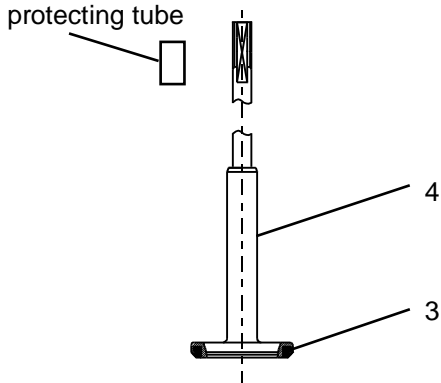

III. Installation of seals and assembly of valve

The item numbers refer to spare parts list
RN 01.054.811 DN / 01.054.812 Inch.

Attention: Provide all seals with a thin layer of grease.

- a. At first, put the O-ring (9) and then the guide bush (10) into the yoke (11). Insert the shaft seal (8) and press in the seat seal (7). **See to the right position of installation.**
- b. Mount the yoke (11) at the actuator (16).
- c. Insert seat seal (3) into the shaft (4). Use the APV assembly tool to install the seat seal, **see chapt. 13**. Grease seat seal only slightly before its installation.
If installed manually, vent the seal groove by means of a thin object between the seal and the groove wall.
- d. Slide the protecting tube over the thread of the guide rod until the tube stops at the first edge.
Slide the shaft (4) through the yoke (11) and the actuator (16).
- e. Remove the protecting tube.
- f. **CU version:**
Attach the centering washer (14). Screw on the hexagon nut (15) and fix it with a tightening torque of **Md = 40 Nm**.
Hold up the centering washer during this process.
CU: Tighten plastic actuator screw.
- Valve position indicator:**
Attach centering washer. Fix metallic actuator screw (19) as hexagon nut. Hold up the centering washer.
Tightening torque **Md = 40 Nm**.
- g. Slightly grease the housing seal (5) and install it in the groove of the yoke flange.

9. Service Instructions

IV. Installation of valve

a. CU version:

Place the control unit (18) on the adapter and secure it with the ring.

Valve position indicator:

Fix the indicator housing (20).

b. To install the valve insert in the design NC, observe the following steps:

Control the actuator with air. Place the valve insert carefully in the housing (1) and tighten the clamp (6). Do not damage the housing seal (5) during the installation.



Do not touch movable valve parts!
Risk of injury by sudden valve operation.

Valve design NC: Shut off air.

c. Valve position indicator:

Plug in proximity switches and fix them.

- Readjust proximity switches if necessary.

d. Check basic adjustment of valve position indicator.

- The shift points can be adjusted by turning the positioning screw in the control unit.

e. Connect steam lines.

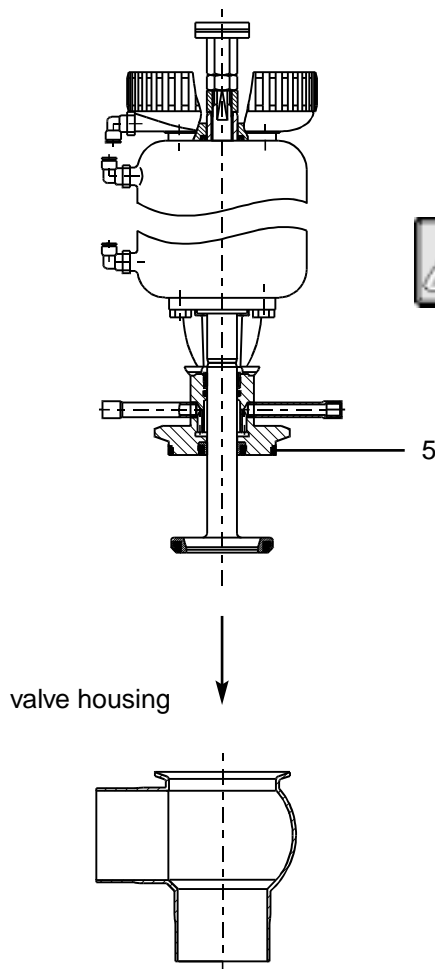

10. Service Instructions

Change-over valves DELTA SW 43, SW 44.
The item numbers refer to spare parts list
RN 01.054.813 DN / 01.054.814 Inch.

I. Disassembly from the line system

- a. Shut off steam and connecting lines, discharge line pressures and empty lines if possible.
- b. Separate steam connections.
- c. Separate electric and pneumatic connections.
- d. Detach connection between the upper housing globe and the connected line.

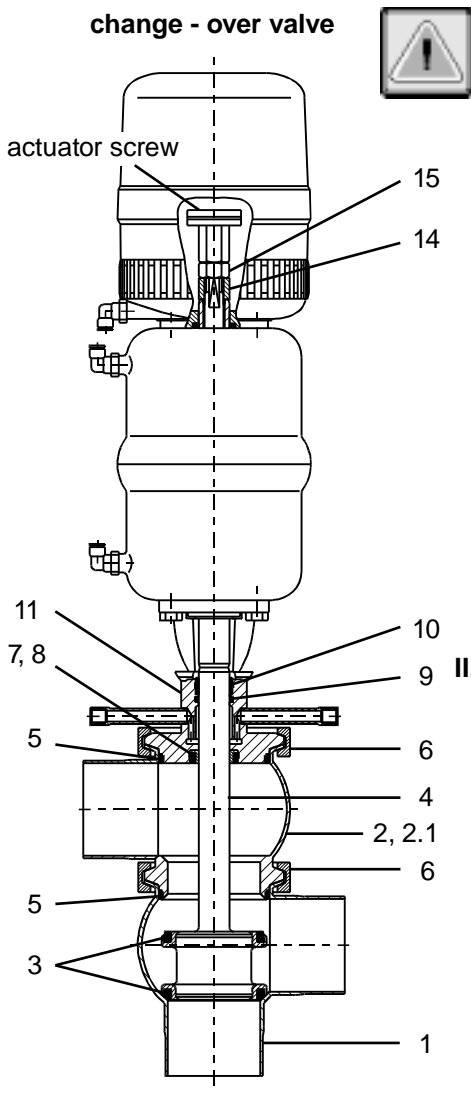

Attention:

- e. **Valve design NC:** control actuator with air.

Do not touch movable valve parts!
Risk of injury by sudden valve operation.

- f. Detach lower clamp (6).
- g. Lift valve insert together with upper housing (2, 2.1) off the lower housing (1).

Attention:

- h. **Valve design NC:** shut off compressed air.

i. CU version:

Detach the control unit by turning the locking ring.

Valve position indicator:

Remove proximity switches. Detach indicator housing (proximity switch holder) from actuator.

II. Dismantling of wear parts (product-wetted parts)

a. Attention:

Valve design NC: Control the actuator with air.

b. CU version:

Unscrew actuator screw, at first. Screw off hexagon nut (15) by holding up the centering washer (14). Remove centering washer.

Valve position indicator:

Unscrew metallic actuator screw (19) by holding up the centering washer (14). Remove centering washer.

- c. Pull valve shaft (4) out of the actuator. Remove seat seal (3).
- d. Detach upper clamp (6) and upper housing (2, 2.1). Remove the two housing seals (5).
- e. Unscrew yoke (11) from actuator.
- f. Detach seat seal (7), shaft seal (8), O-ring (9) and guide bush (10).

10. Service Instructions

valve position indicator

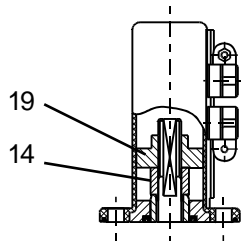

actuator screw

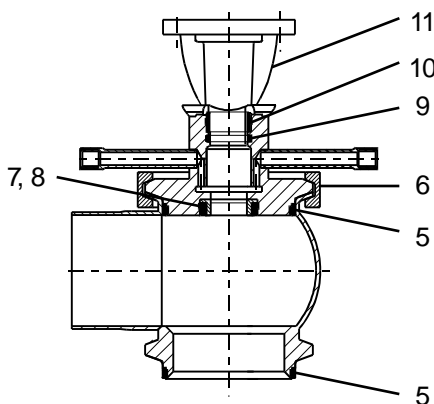
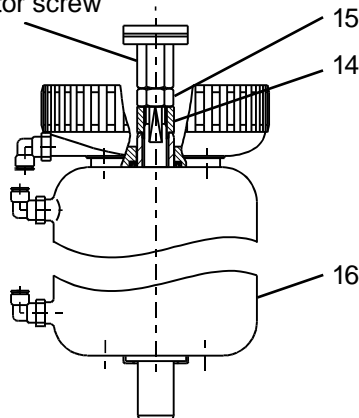

protecting tube

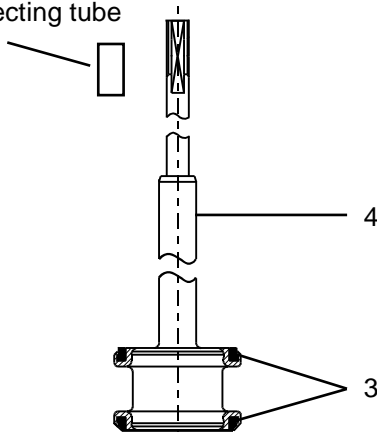

Change-over valves DELTA SW 43, SW 44.
The item numbers refer to spare parts list
RN 01.054.813 DN / 01.054.814 Inch.

Attention: Provide all seals with a thin layer of grease.

- a. At first, put the O-ring (9) and then the guide bush (10) into the yoke (11). Insert the shaft seal (8) and press in the seat seal (7). See to the right position of installation.
- b. Mount the yoke (11) at the actuator (16).
- c. Insert seat seal (3) into the shaft (4). Use the APV assembly tool to install the seat seal, **see chapt. 13**. Grease seat seal only slightly before its installation.
If installed manually, vent the seal groove by means of a thin object between the seal and the groove wall.
- d. Slightly grease the housing seals (5) and install them in the grooves of the yoke flange and the upper housing (2, 2.1).
- e. Slide the upper housing (2, 2.1) on the yoke (11).
Fix the upper clamp (6).

Attention:

Valve design NC: control the valve with air.

- f. Slide the protecting tube over the thread of the guide rod until the tube stops at the first edge.
Slide the shaft (4) through the yoke (11) and the actuator (16).
- g. Remove the protecting tube.
- h. **CU version:**
Attach the centering washer (14). Screw on the hexagon nut (15) and fix it with a tightening torque of **Md = 40 Nm**. Hold up the centering washer during this process.
CU: Tighten plastic actuator screw.

Valve position indicator:

Attach centering washer. Fix metallic actuator screw (19) as hexagon nut. Hold up the centering washer.
Tightening torque **Md = 40 Nm**.

- i. **Attention:**
Valve design NO: Shut off control air.

10. Service Instructions

valve position indicator

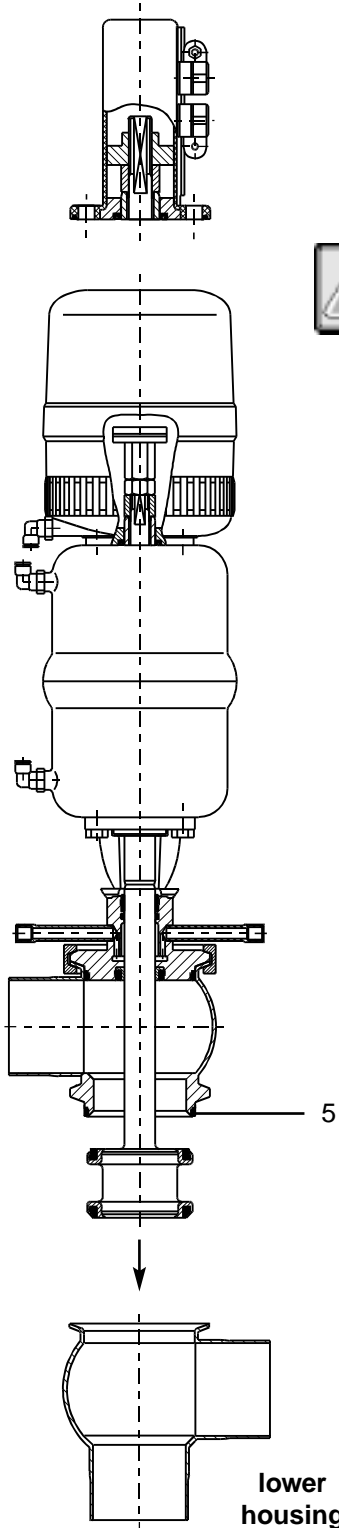

IV. Installation of valve

a. CU version:

Place the control unit (18) on the adapter and secure it with the ring.

Valve position indicator:

Fix the indicator housing (20).

b. Valve design NC: control actuator with air.



Do not touch movable valve parts!

Risk of injury by sudden valve operation.

c. Place the valve insert carefully in the lower housing and tighten the lower clamp (6). Do not damage the housing seal (5) during the installation.

Valve design NC: Shut off compressed air.

d. Valve position indicator:

Plug in proximity switches and fix them.

- Readjust proximity switches if necessary.

e. Check basic adjustment of valve position indicator.

- The shift points can be adjusted by turning the positioning screw in the control unit.

f. Connect steam lines.

11. Maintenance of Actuator

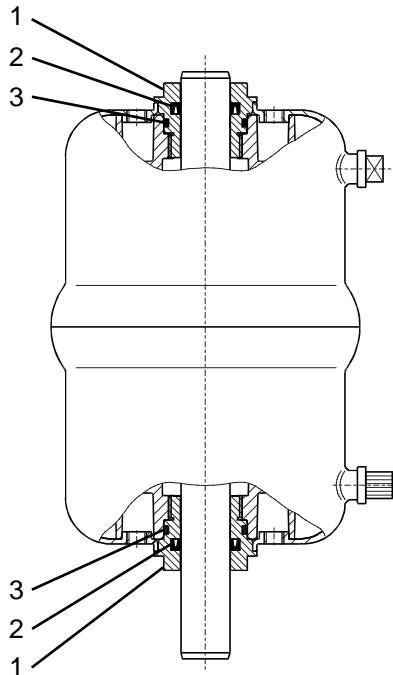

- a. Remove the air hose from the actuator.
- b. Remove the inner hexagon screw from the adapter of the control unit.
- c. Unscrew the two seal screws **(1)** by holding up the actuator with a strap wrench. Remove O-rings **(3)** and V-seals **(2)**.

Installation of seals and assembly of actuator

- a. Install the greased O-rings **(3)** and the V-seal **(2)** in the seal screw **(1)**.

See to the right installing direction of the V-seal.

- b. Slide the seal screws at both sides of the actuator over the piston rod and tighten them.
- c. Fasten the adapter for the control unit and the yoke on the actuator.

Attention: Observe the position of the adapter.

Attention: Observe the required valve design NC or NO during the assembly of the adapter and of the yoke.

- d. Attach the air hoses.

12. Reconstruction of Actuator

With SW4 valves the sizes of the actuator and the effective direction can be modified.

To increase and reduce the actuator sizes (Ø 74mm, Ø 110mm, Ø 165mm), observe the corresponding line pressures, see table page 7.

I. Change of actuator sizes

Disassembly

- a. The disassembly of single seat change-over valves is undertaken as described in the service instructions.
- b. To modify the actuator size, replace the guide rod **(13)** as follows:

Clamp the valve seat in a vice.

Attention: Prevent damage to the seat (use protective covers or cleaning rags). The slightest damage at the shaft rod can produce leakages.

- c. Remove the guide rod from the shaft by means of the centering washer **(14)** and a wrench SW 17.

Assembly

- a. Install the corresponding guide rod at the actuator in the shaft.
Tightening torque: 40 Nm.
- b. Further assembly as described.

II. Modification of effective direction

By turning the actuator by 180°, the design **NC** or **NO** can be modified.

NC = normally closed / air-to-raise, spring-to-lower ("fail-down")

NO = normally open / air-to-lower, spring-to-raise ("fail-up")

13. Assembly Tool

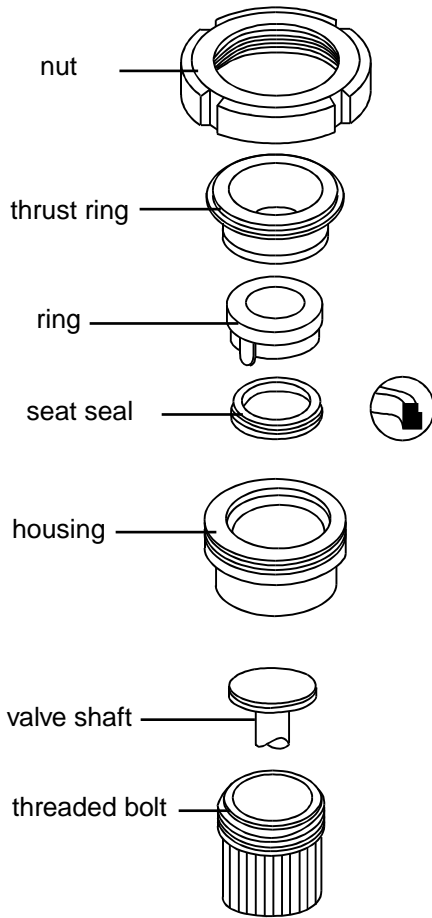

The assembly tool consists of:

- nut
- thrust ring
- ring with venting plug
- housing
- threaded bolt

Installation of seat seal in the valve shaft

1. Insert valve shaft in the housing in such a manner that the seal groove is in the valve housing.
2. Fix the shaft in the housing by means of the threaded bolt. Clamp the housing into a vise.
3. Lightly grease the seat seal with APV food-grade grease. Slide seal onto the ring with venting plug until it stops.
4. Insert the ring with the seat seal into the housing and press it down until it stops.
5. Insert the thrust ring into the housing. Screw on nut and tighten it by a hook spanner until it stops.
6. Release nut. Take ring and thrust ring out of the housing.
7. Take housing out of the vice, release threaded bolts. Take the valve shaft out of the housing.

Check the right fit of the seat seal.

Assembly tool for seat seal SW4

DN	Tube	ref.-No.:
25	1"	000 51 - 13 - 110/17
40	1,5"	000 51 - 13 - 111/17
50	2"	000 51 - 13 - 112/17
65		000 51 - 13 - 113/17
	2,5"	000 51 - 13 - 120/17
	3"	000 51 - 13 - 121/17
80		000 51 - 13 - 114/17
100	4"	000 51 - 13 - 115/17

14. Trouble shooting

The item numbers refer to the spare parts drawings.

- Valve leaks : Replace seat seal **(3)**.
Check line pressure:
safe line pressure, see chapt. 7.
- Housing leaks around the clamp : Replace housing seal **(5)**.
- Shaft passage in the yoke is untight : Replace shaft seal **(7, 8)**,
O-ring **(9)** and guide bush **(10)**.
- Product leakage at the steam outlet : Replace shaft seal **(7, 8)**.
- Air escapes from the actuator (see spare parts list RN: 01.054.86) : Dismantle actuator **(16)** from valve,
replace V-seal **(2)** and O-ring **(3)** in the seal screw **(1)**.
- Actuator does not work, air escapes permanently from the venting plug : Replace actuator.
- Valve feedback is missing or unprecise : Undertake fine adjustment according to service instructions of control unit.



15. Spare Parts Lists

(see annex)

BA SW4DPF 0002
ID-No.: H 2 0 6 8 1 7
Translation of original manual



rev. 0



Your local contact:



APV
Zeichenstraße 49
D-59425 Unna

Phone: +49(0) 23 03/ 108-0 Fax: +49(0) 23 03 / 108-210

For more information about our worldwide locations, approvals, certifications, and local representatives, please visit www.apv.com.

Copyright © 2008 SPX Corporation

The information contained in this document, including any specifications and other product details, are subject to change without notice. While we have taken care to ensure the information is accurate at the time of going to press, we assume no responsibility for errors or omissions nor for any damages resulting from the use of the information contained herein.



Weitergabe sowie Vervielfältigung dieser Unterlage, Verwertung und Mitteilung ihres Inhalts nicht gestattet, soweit nicht schriftlich zugestanden. Verstöß verpflichtet zum Schadensersatz und kann strafrechtliche Folgen haben (Paragraf 18 UWG, Paragraf 106 UWG). Eigentum und alle Rechte, auch für Patenterteilung und Gebrauchsmustereintragung, vorbehalten. APV Rosista GmbH. Diese Zeichnung wurde mit CAD erstellt und darf nicht von Hand geändert werden.

02/94

Ersatzteilliste: spare parts list:		Besteht aus <u>3</u> Blatt		Blatt <u>1</u>	
Ventil SWDPF41, 42, SWEDPF4-FS-CU und VSM DN25-100		Gezeichnet	24.01.02	Name	Trytko
Single seat valve with steam barrier SWDPF41, 42		Geprüft			
SWEDPF4-FS-CU and PSH DN 25-100		Normgepr.			
Datum	01/02				
Name	Trytko				
		RN 01.054.86		RN 01.054.811	



Es stehen verschiedene Dichtungswerkstoffe zur Verfügung. Bitte WS-Nr. ergänzen

The following seal materials are available (fill in last two digits of ref.-no.)

- *Dichtungswerkstoff: material seals:
- ../13-VMQ/Silicone
- ../33-HNBR
- ../73-FPM
- ../93-EPDM

Gehäusedichtung /housing seal
Bei VMQ wird die HNBR-Gehäusedichtung eingesetzt.
For VMQ take the HNBR-housing seal.

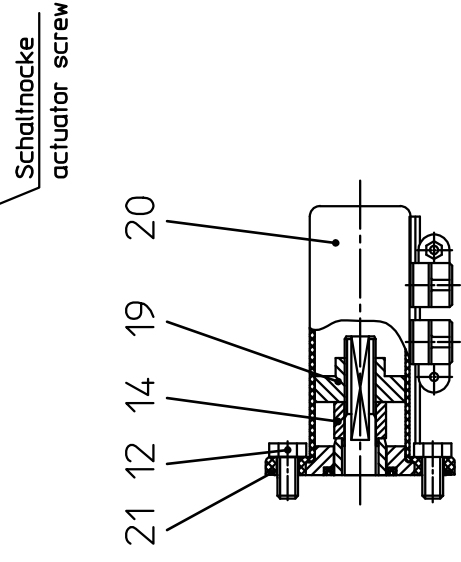
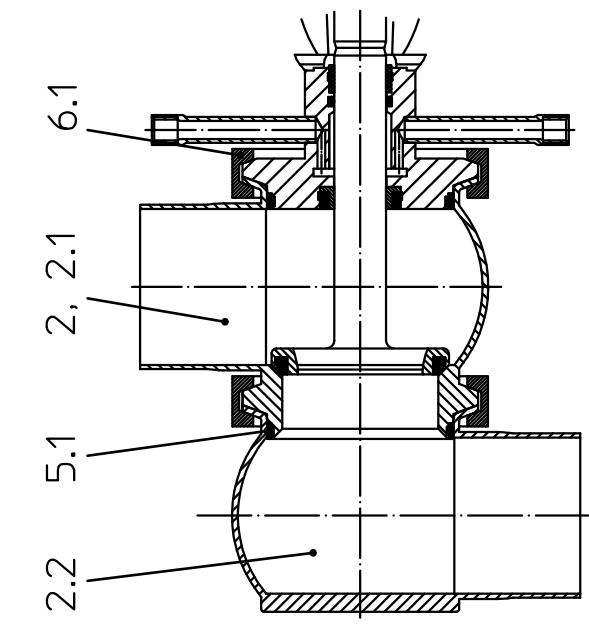
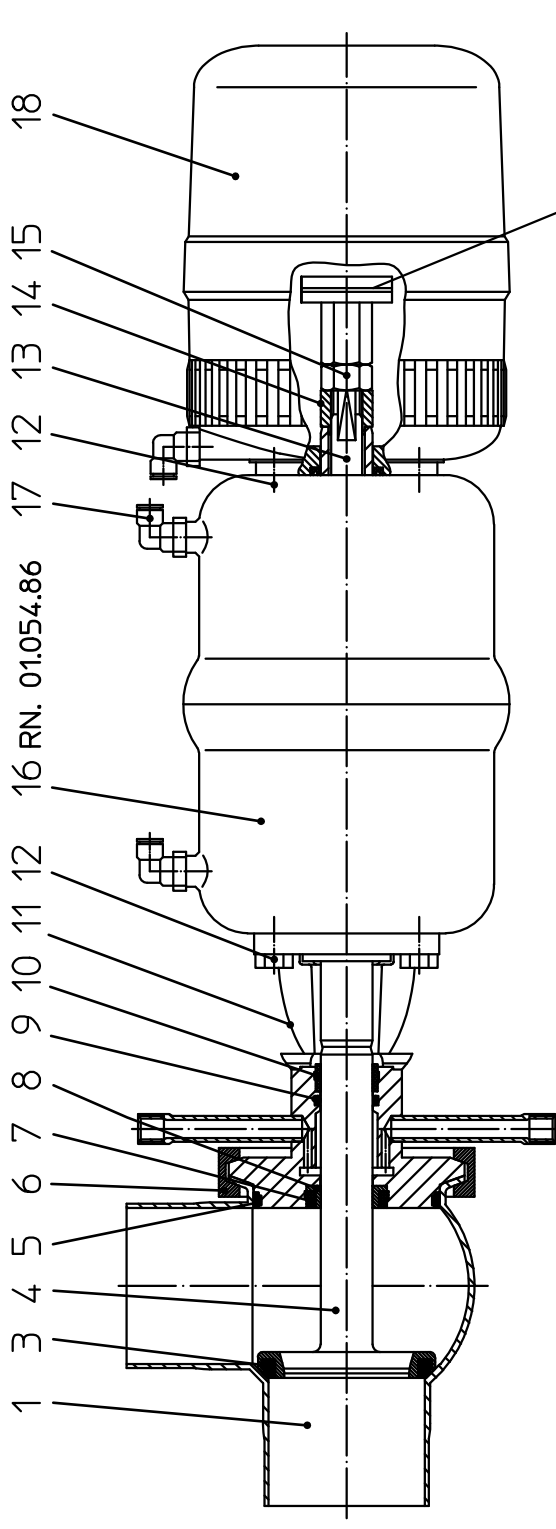

Weitergabe sowie Vervielfältigung dieser Unterlage, Verwertung und Mitteilung ihres Inhaltes nicht gestattet, soweit nicht schriftlich zugestanden. Verstößt verpflichtet zum Schadensersatz und kann strafrechtliche Folgen haben (Paragraf 18 UWG, Paragraf 106 UrhG). Eigentum und alle Rechte, auch für Patenterteilung und Gebrauchsmusteranmeldung, vorbehalten. APV Rosista GmbH. Diese Zeichnung wurde mit CAD erstellt und darf nicht von Hand geändert werden.

02/94

Ersatzteilliste: spare parts list:
 Ventil SWDPF41, 42, SWEDPF4-FS-CU und VSM DN25-100
 Single seat valve with steam barrier SWDPF41, 42,
 SWEDPF4-FS-CU and PSH DN25-100

Blatt 3

Gezeichnet	24.01.02	Name	Trytko
Geprüft	06.03.02	Gezeichnet	Trytko
Normgepr.		Geprüft	Splithoff

RN 01.054.811



APV Rosista GmbH
 D-58425 Unna
 Germany

Pos. item	Benennung description	DN												
		25	40	50	65	80	100	125	150	WS-Nr. ref.-no.	WS-Nr. ref.-no.			
14	Zentrierscheibe Centering washer	15-28-940/12	=	=	=	=	=	=	=	=	=	=		
15	Skt. Mutter Hex. nut	65-50-101/15	=	=	=	=	=	=	=	=	=	=		
16	Steuerkopf Actuator	15-32-050/17	=	15-32-051/17	=	15-32-052/17	=	=	=	=	=	=		
17	W-Verschraubung Angular union	08-60-750/93	=	=	=	=	=	=	=	=	=	=		
18	Control-Unit CU31 Control-Unit CU31	16-31-232/93	=	=	=	=	=	=	=	=	=	=		
19	Schaltnocke Operating cam	08-52-290/97	08-52-291/97	=	=	=	=	=	=	=	=	=		
20	Ventilstellungsmeldung (VSM) SW4 Proximity switch holder (PSH) SW4	15-33-932/93	=	=	=	=	=	=	=	=	=	=		
21	O-Ring O-ring	OR 66x2 NBR 70 Shore A												

Pos. 3, 5, 5.1, 7, 8, 9, 10 nur im kompletten Dichtungssatz erhältlich
 Item 3, 5, 5.1, 7, 8, 9, 10 available es complete seal kits only

SWDPF41, SWDPF42, SWEDPF43, SWEDPF44

1	Dichtungssatz Seal kit	FPM	58-34-810/00	58-34-811/00	58-34-812/00	58-34-813/00	58-34-814/00	58-34-815/00						
1	Dichtungssatz Seal kit	EPDM	58-34-810/01	58-34-811/01	58-34-812/01	58-34-813/01	58-34-814/01	58-34-815/01						
1	Dichtungssatz Seal kit	VMQ	58-34-810/02	58-34-811/02	58-34-812/02	58-34-813/02	58-34-814/02	58-34-815/02						
1	Dichtungssatz Seal kit	HNBR	58-34-810/06	58-34-811/06	58-34-812/06	58-34-813/06	58-34-814/06	58-34-815/06						
	SWEDPF41, SWEDPF42													
1	Dichtungssatz Seal kit	FPM	58-34-816/00	58-34-817/00	58-34-818/00	58-34-819/00	58-34-820/00	58-34-821/00						
1	Dichtungssatz Seal kit	EPDM	58-34-816/01	58-34-817/01	58-34-818/01	58-34-819/01	58-34-820/01	58-34-821/01						
1	Dichtungssatz Seal kit	VMQ	58-34-816/02	58-34-817/02	58-34-818/02	58-34-819/02	58-34-820/02	58-34-821/02						
1	Dichtungssatz Seal kit	HNBR	58-34-816/06	58-34-817/06	58-34-818/06	58-34-819/06	58-34-820/06	58-34-821/06						

Weitergabe sowie Vervielfältigung dieser Unterlage, Verwertung und Mitteilung ihres Inhalts nicht gestattet, soweit nicht schriftlich zugestanden. Verstöß verpflichtet zum Schadensersatz und kann strafrechtliche Folgen haben (Paragraf 18 UWG, Paragraf 106 Urtg.). Eigentum und alle Rechte, auch für Patentierung und Gebrauchsmustereintragung, vorbehalten. APV Rosista GmbH. Diese Zeichnung wurde mit CAD erstellt und darf nicht von Hand geändert werden.

02/94

Ersatzteilliste: spare parts list:
 Ventil SWDPF41, 42, SWEDPF4-FS-CU und VSM 1-4 Zoll
 Single seat valve with steam barrier SWDPF41, 42
 SWEDPF4-FS-CU and PSH 1-4 inch

Besteht aus 3 Blatt		Blatt 1	
Gezeichnet	28.01.02	Trytko	
Geprüft	06.03.02	Spieihoff	
Normgepr.			
Datum	01/02	04/04	
Name	Trytko	Trytko	

APV Rosista GmbH
 D-59425 Urra
 Germany

RN 01.054.812

Es stehen verschiedene Dichtungswerkstoffe zur Verfügung. Bitte WS-Nr. ergänzen

The following seal materials are available (fill in last two digits of ref.-no.)

- *Dichtungswerkstoff: material seals:
- ../13-VMQ
- ../33-HNBR
- ../73-FPM
- ../93-EPDM

Gehäusedichtung /housing seal
 Bei VMQ wird die HNBR-Gehäusedichtung eingesetzt.
 For VMQ take the HNBR-housing seal.

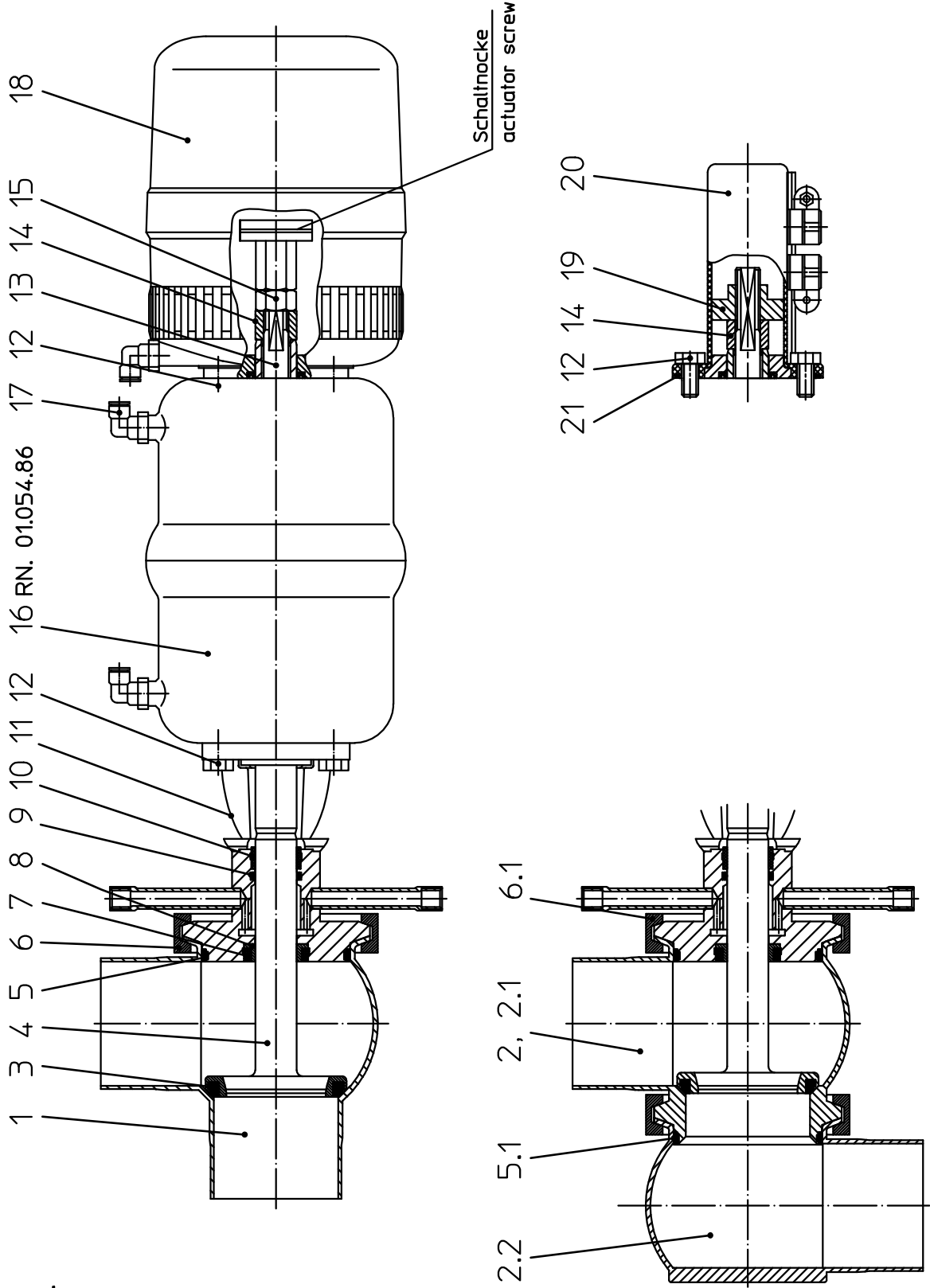

Weitergabe sowie Vervielfältigung dieser Unterlage, Verwertung und Mitteilung ihres Inhalts ist gestattet, soweit nicht schriftlich zugestanden, Verstoß verpflichtet zum Schadensersatz und kann strafrechtliche Folgen haben (Paragraf 18 UWG, Paragraph 106 UrtG). Eigentum und alle Rechte, auch für Patenterteilung und Gebrauchsmustererlangung, vorbehalten. APV Rosista GmbH. Diese Zeichnung wurde mit CAD erstellt und darf nicht von Hand geändert werden.

Ersatzteilliste: spare parts list:

Ventil SWDPF41, 42, SWEDPF4-FS-CU und VSM 1-4 Zoll
Single seat valve with steam barrier SWDPF41, 42,
SWEDPF4-FS-CU and PSH 1-4 inch

Blatt 2

Gezeichnet 28.01.02 Trytko
Geprüft 06.03.02 Spliethoff

Datum 28.01.02
Name Trytko

APV Rosista GmbH
D-58425 Unna
Germany

Datum 01/02 11/02 04/04 08/06 08/07
Name Trytko Trytko Trytko Trytko Trytko

Normgepr.
 RN 01.054.812

Pos. item	Benennung description	1"				1,5"				2"				2,5"				3"				4"			
		WS-Nr. ref.-no.	WS-Nr. ref.-no.	WS-Nr. ref.-no.	WS-Nr. ref.-no.	WS-Nr. ref.-no.	WS-Nr. ref.-no.	WS-Nr. ref.-no.	WS-Nr. ref.-no.	WS-Nr. ref.-no.	WS-Nr. ref.-no.	WS-Nr. ref.-no.	WS-Nr. ref.-no.	WS-Nr. ref.-no.	WS-Nr. ref.-no.	WS-Nr. ref.-no.	WS-Nr. ref.-no.	WS-Nr. ref.-no.	WS-Nr. ref.-no.	WS-Nr. ref.-no.	WS-Nr. ref.-no.				
1	Gehäuse Housing SW41	15-60-315/47	15-60-415/47	15-60-465/47	15-60-515/47	15-60-565/47	15-60-615/47	15-60-665/47	15-60-715/47	15-60-765/47	15-60-815/47	15-60-865/47	15-60-915/47	15-60-965/47	15-60-1015/47	15-60-1065/47	15-60-1115/47	15-60-1165/47	15-60-1215/47	15-60-1265/47	15-60-1315/47	15-60-1365/47			
1	Gehäuse Housing SW42	15-61-315/47	15-61-415/47	15-61-465/47	15-61-515/47	15-61-565/47	15-61-615/47	15-61-665/47	15-61-715/47	15-61-765/47	15-61-815/47	15-61-865/47	15-61-915/47	15-61-965/47	15-61-1015/47	15-61-1065/47	15-61-1115/47	15-61-1165/47	15-61-1215/47	15-61-1265/47	15-61-1315/47	15-61-1365/47			
1	Gehäuse Housing SWE43	15-66-305/47	15-66-405/47	15-66-455/47	15-66-505/47	15-66-555/47	15-66-605/47	15-66-655/47	15-66-705/47	15-66-755/47	15-66-805/47	15-66-855/47	15-66-905/47	15-66-955/47	15-66-1005/47	15-66-1055/47	15-66-1105/47	15-66-1155/47	15-66-1205/47	15-66-1255/47	15-66-1305/47	15-66-1355/47			
1	Gehäuse Housing SWE44	15-67-305/47	15-67-405/47	15-67-455/47	15-67-505/47	15-67-555/47	15-67-605/47	15-67-655/47	15-67-705/47	15-67-755/47	15-67-805/47	15-67-855/47	15-67-905/47	15-67-955/47	15-67-1005/47	15-67-1055/47	15-67-1105/47	15-67-1155/47	15-67-1205/47	15-67-1255/47	15-67-1305/47	15-67-1355/47			
2	Gehäuse Oberteil Housing upper part SWE41	15-62-010/47	15-62-011/47	15-62-012/47	15-62-013/47	15-62-014/47	15-62-015/47	15-62-016/47	15-62-017/47	15-62-018/47	15-62-019/47	15-62-020/47	15-62-021/47	15-62-022/47	15-62-023/47	15-62-024/47	15-62-025/47	15-62-026/47	15-62-027/47	15-62-028/47	15-62-029/47	15-62-030/47			
2.1	Gehäuse Oberteil Housing upper part SWE42	15-63-010/47	15-63-011/47	15-63-012/47	15-63-013/47	15-63-014/47	15-63-015/47	15-63-016/47	15-63-017/47	15-63-018/47	15-63-019/47	15-63-020/47	15-63-021/47	15-63-022/47	15-63-023/47	15-63-024/47	15-63-025/47	15-63-026/47	15-63-027/47	15-63-028/47	15-63-029/47	15-63-030/47			
2.2	Gehäuse Unterteil Housing lower part SWE41,42	15-60-110/47	15-60-111/47	15-60-112/47	15-60-113/47	15-60-114/47	15-60-115/47	15-60-116/47	15-60-117/47	15-60-118/47	15-60-119/47	15-60-120/47	15-60-121/47	15-60-122/47	15-60-123/47	15-60-124/47	15-60-125/47	15-60-126/47	15-60-127/47	15-60-128/47	15-60-129/47	15-60-130/47			
3	Tellerdichtung Seat seal *	58-33-293/	58-33-393/	58-33-443/	58-33-124/	58-33-124/	58-33-124/	58-33-124/	58-33-124/	58-33-124/	58-33-124/	58-33-124/	58-33-124/	58-33-124/	58-33-124/	58-33-124/	58-33-124/	58-33-124/	58-33-124/	58-33-124/	58-33-124/				
4	Ven. Schaft Valve shaft	15-25-311/42	15-25-406/42	15-25-456/42	15-25-506/42	15-25-556/42	15-25-606/42	15-25-656/42	15-25-706/42	15-25-756/42	15-25-806/42	15-25-856/42	15-25-906/42	15-25-956/42	15-25-1006/42	15-25-1056/42	15-25-1106/42	15-25-1156/42	15-25-1206/42	15-25-1256/42	15-25-1306/42	15-25-1356/42			
5	Gehäusedichtung Housing seal SW41,42 SWE43,44 *	58-33-267/	58-33-292/	58-33-124/	58-33-125/	58-33-125/	58-33-125/	58-33-125/	58-33-125/	58-33-125/	58-33-125/	58-33-125/	58-33-125/	58-33-125/	58-33-125/	58-33-125/	58-33-125/	58-33-125/	58-33-125/	58-33-125/	58-33-125/				
5.1	Gehäusedichtung Housing seal SWE41,42 *	58-33-267/	58-33-292/	58-33-124/	58-33-125/	58-33-125/	58-33-125/	58-33-125/	58-33-125/	58-33-125/	58-33-125/	58-33-125/	58-33-125/	58-33-125/	58-33-125/	58-33-125/	58-33-125/	58-33-125/	58-33-125/	58-33-125/	58-33-125/				
6	Gelenkklemme Clamp SW41,42 SWE43,44	42-40-287/17	42-40-387/17	42-40-437/17	42-40-487/17	42-40-537/17	42-40-587/17	42-40-637/17	42-40-687/17	42-40-737/17	42-40-787/17	42-40-837/17	42-40-887/17	42-40-937/17	42-40-987/17	42-40-1037/17	42-40-1087/17	42-40-1137/17	42-40-1187/17	42-40-1237/17	42-40-1287/17	42-40-1337/17			
6.1	Gelenkklemme Clamp SWE41,42	42-40-287/17	42-40-387/17	42-40-437/17	42-40-487/17	42-40-537/17	42-40-587/17	42-40-637/17	42-40-687/17	42-40-737/17	42-40-787/17	42-40-837/17	42-40-887/17	42-40-937/17	42-40-987/17	42-40-1037/17	42-40-1087/17	42-40-1137/17	42-40-1187/17	42-40-1237/17	42-40-1287/17	42-40-1337/17			
7	Tellerdichtung Seat seal *	58-33-293/	58-33-393/	58-33-443/	58-33-124/	58-33-124/	58-33-124/	58-33-124/	58-33-124/	58-33-124/	58-33-124/	58-33-124/	58-33-124/	58-33-124/	58-33-124/	58-33-124/	58-33-124/	58-33-124/	58-33-124/	58-33-124/	58-33-124/				
8	Schaftdichtung Shaft seal	58-33-150/26	58-33-150/26	58-33-150/26	58-33-150/26	58-33-150/26	58-33-150/26	58-33-150/26	58-33-150/26	58-33-150/26	58-33-150/26	58-33-150/26	58-33-150/26	58-33-150/26	58-33-150/26	58-33-150/26	58-33-150/26	58-33-150/26	58-33-150/26	58-33-150/26	58-33-150/26				
9	O-Ring O-ring OR 20,2x3	58-06-078/64	58-06-078/64	58-06-078/64	58-06-078/64	58-06-078/64	58-06-078/64	58-06-078/64	58-06-078/64	58-06-078/64	58-06-078/64	58-06-078/64	58-06-078/64	58-06-078/64	58-06-078/64	58-06-078/64	58-06-078/64	58-06-078/64	58-06-078/64	58-06-078/64	58-06-078/64				
10	Führungsbuchse Bushing	08-01-178/23	08-01-178/23	08-01-178/23	08-01-178/23	08-01-178/23	08-01-178/23	08-01-178/23	08-01-178/23	08-01-178/23	08-01-178/23	08-01-178/23	08-01-178/23	08-01-178/23	08-01-178/23	08-01-178/23	08-01-178/23	08-01-178/23	08-01-178/23	08-01-178/23	08-01-178/23				
11	Laterne Yoke	15-40-973/47	15-40-974/47	15-40-975/47	15-40-977/47	15-40-978/47	15-40-979/47	15-40-980/47	15-40-981/47	15-40-982/47	15-40-983/47	15-40-984/47	15-40-985/47	15-40-986/47	15-40-987/47	15-40-988/47	15-40-989/47	15-40-990/47	15-40-991/47	15-40-992/47	15-40-993/47	15-40-994/47			
12	Skt. Schraube Hex. screw	DIN EN 24017-M8x16-A2-70	DIN EN 24017-M8x16-A2-70	DIN EN 24017-M8x16-A2-70	DIN EN 24017-M8x16-A2-70	DIN EN 24017-M8x16-A2-70	DIN EN 24017-M8x16-A2-70	DIN EN 24017-M8x16-A2-70	DIN EN 24017-M8x16-A2-70	DIN EN 24017-M8x16-A2-70	DIN EN 24017-M8x16-A2-70	DIN EN 24017-M8x16-A2-70	DIN EN 24017-M8x16-A2-70	DIN EN 24017-M8x16-A2-70	DIN EN 24017-M8x16-A2-70	DIN EN 24017-M8x16-A2-70	DIN EN 24017-M8x16-A2-70	DIN EN 24017-M8x16-A2-70	DIN EN 24017-M8x16-A2-70	DIN EN 24017-M8x16-A2-70	DIN EN 24017-M8x16-A2-70				
13	Zugstange Guide rod	15-23-850/12	15-23-851/12	15-23-852/12	15-23-853/12	15-23-854/12	15-23-855/12	15-23-856/12	15-23-857/12	15-23-858/12	15-23-859/12	15-23-860/12	15-23-861/12	15-23-862/12	15-23-863/12	15-23-864/12	15-23-865/12	15-23-866/12	15-23-867/12	15-23-868/12	15-23-869/12	15-23-870/12			

Weitergabe sowie Vervielfältigung dieser Unterlage, Verwertung und Mitteilung ihres Inhalts ist gestattet, soweit nicht schriftlich zugestanden. Verstößt verpflichtet zum Schadensersatz und kann strafrechtliche Folgen haben (Paragraf 18 UWG, Paragraph 106 UrhG, Eigentum und alle Rechte, auch für Patenterteilung und Gebrauchsmusteranmeldung, vorbehalten. APV Rosista GmbH. Diese Zeichnung wurde mit CAD erstellt und darf nicht von Hand geändert werden.

Ersatzteilliste: spare parts list:
 Ventil SWDPF41, 42, SWEDPF4-FS-CU und VSM 1-4 Zoll
 Single seat valve with steam barrier SWDPF41, 42,
 SWEDPF4-FS-CU and PSH 1-4 inch

Blatt 3

Gezeichnet	24.01.02	Trytko	
Geprüft	06.03.02	Splithoff	
Normgepr.			
Datum	01/02	11/02	04/04
Name	Trytko	Trytko	Trytko

RN 01.054.812



APV Rosista GmbH
 D-58425 Unna
 Germany

Pos. item	Benennung description	1"		1,5"		2"		2,5"		3"		4"	
		WS-Nr. ref.-no.	WS-Nr. ref.-no.	WS-Nr. ref.-no.	WS-Nr. ref.-no.	WS-Nr. ref.-no.	WS-Nr. ref.-no.	WS-Nr. ref.-no.	WS-Nr. ref.-no.	WS-Nr. ref.-no.	WS-Nr. ref.-no.	WS-Nr. ref.-no.	
14	Zentrierscheibe Centering washer	15-28-940/12	=	=	=	=	=	=	=	=	=	=	WS-Nr. ref.-no.
15	Skt. Mutter Hex. nut	65-50-101/15	=	=	=	=	=	=	=	=	=	=	WS-Nr. ref.-no.
16	Steuerkopf Actuator	15-32-050/17	=	15-32-051/17	=	15-32-052/17	=	=	=	=	=	=	WS-Nr. ref.-no.
17	W-Verschraubung Angular union	08-60-750/93	=	=	=	=	=	=	=	=	=	=	WS-Nr. ref.-no.
18	Control-Unit CU31 Control-Unit CU31	16-31-232/93	=	=	=	=	=	=	=	=	=	=	WS-Nr. ref.-no.
19	Schaltnocke Operating cam	08-52-290/97	08-52-291/97	=	=	=	=	=	=	=	=	=	WS-Nr. ref.-no.
20	Ventilstellungsmeldung (VSM) SW4 Proximity switch holder (PSH) SW4	15-33-932/93	=	=	=	=	=	=	=	=	=	=	WS-Nr. ref.-no.
21	O-Ring O-ring	OR 66x2 NBR 70 Shore A											

Pos. 3, 5, 5.1, 7, 8, 9, 10 nur im kompletten Dichtungssatz erhältlich
 Item 3, 5, 5.1, 7, 8, 9, 10 available es complete seal kits only

SWDPF41, SWDPF42, SWEDPF43, SWEDPF44														
1	Dichtungssatz Seal kit	FPM	58-34-810/00	58-34-811/00	58-34-812/00	58-34-832/00	58-34-833/00	58-34-815/00						
1	Dichtungssatz Seal kit	EPDM	58-34-810/01	58-34-811/01	58-34-812/01	58-34-832/01	58-34-833/01	58-34-815/01						
1	Dichtungssatz Seal kit	VMQ	58-34-810/02	58-34-811/02	58-34-812/02	58-34-832/02	58-34-833/02	58-34-815/02						
1	Dichtungssatz Seal kit	HNBR	58-34-810/06	58-34-811/06	58-34-812/06	58-34-832/06	58-34-833/06	58-34-815/06						
SWEDPF41, SWEDPF42														
1	Dichtungssatz Seal kit	FPM	58-34-816/00	58-34-817/00	58-34-818/00	58-34-834/00	58-34-835/00	58-34-821/00						
1	Dichtungssatz Seal kit	EPDM	58-34-816/01	58-34-817/01	58-34-818/01	58-34-834/01	58-34-835/01	58-34-821/01						
1	Dichtungssatz Seal kit	VMQ	58-34-816/02	58-34-817/02	58-34-818/02	58-34-834/02	58-34-835/02	58-34-821/02						
1	Dichtungssatz Seal kit	HNBR	58-34-816/06	58-34-817/06	58-34-818/06	58-34-834/06	58-34-835/06	58-34-821/06						

Weitergabe sowie Vervielfältigung dieser Unterlage, Verwertung und Mitteilung ihres Inhalts nicht gestattet, soweit nicht schriftlich zugestanden. Verstößt verpflichtet zum Schadensersatz und kann strafrechtliche Folgen haben (Paragraf 18 UWG, Paragraf 106 Urtg.). Eigentum und alle Rechte, auch für Patenterteilung und Gebrauchsmustererlangung, vorbehalten. APV Rosista GmbH. Diese Zeichnung wurde mit CAD erstellt und darf nicht von Hand geändert werden.

02/94

Ersatzteilliste: spare parts list:
 Umschaltventil SWDPF43, SWDPF44-FS-CU und VSM
 Change over valve with steam barrier SWDPF43,
 SWDPF44-FS-CU and PSH DN 25-100

Besteht aus <u>3</u> Blatt		Blatt <u>1</u>	
Gezeichnet	29.01.02	Name	Trytko
Geprüft			
Normgepr.			
Datum	01/02	Datum	
Name	Trytko		
RN 01.054.813			



APV Rosista GmbH
 D-59425 Urena
 Germany

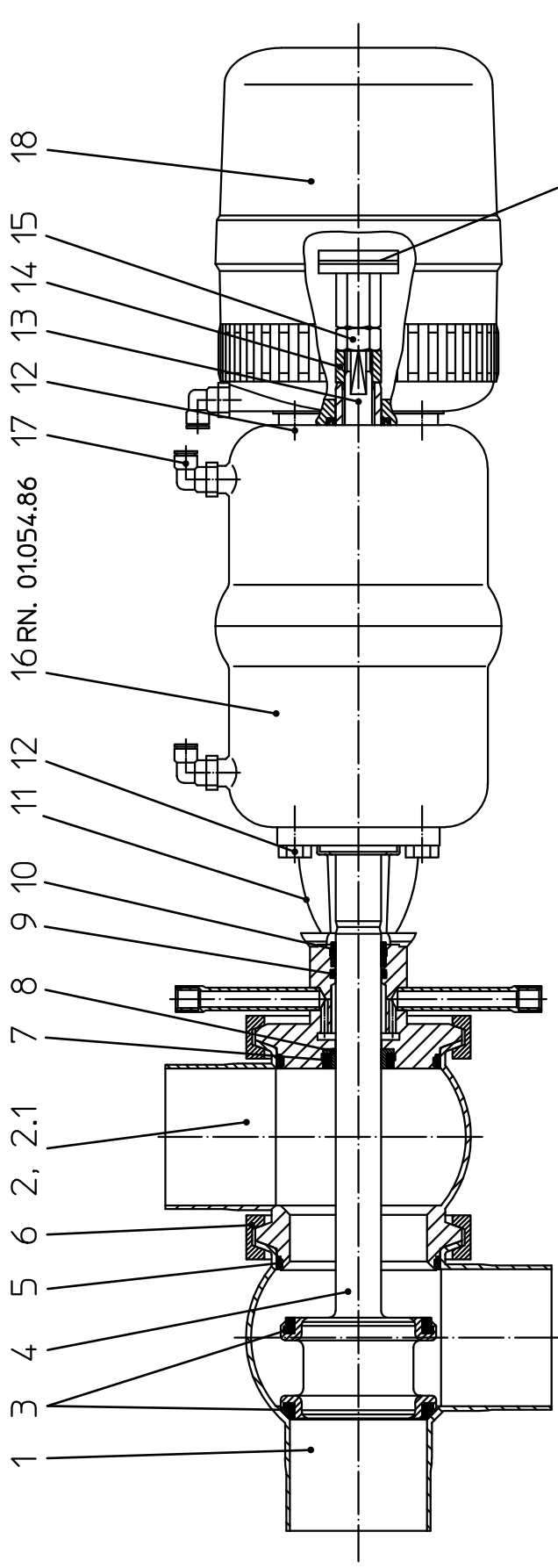

Schaltnocke
 actuator screw

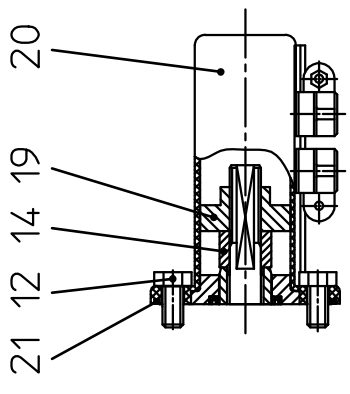

Es stehen verschiedene Dichtungswerkstoffe zur Verfügung. Bitte WS-Nr. ergänzen

The following seal materials are available (fill in last two digits of ref.-no.)

- * Dichtungswerkstoff: material seals:
- ../13-VMQ/Silicone
- ../33-HNBR
- ../73-FPM
- ../93-EPDM

Gehäusedichtung /housing seal
 Bei VMQ wird die HNBR-Gehäusedichtung eingesetzt.
 For VMQ take the HNBR-housing seal.

Weitergabe sowie Vervielfältigung dieser Unterlage, Verwertung und Mitteilung ihres Inhalts ist gestattet, soweit nicht schriftlich zugestanden. Verstoß verpflichtet zum Schadensersatz und kann strafrechtliche Folgen haben (Paragraf 18 UWG, Paragraf 106 UrhG). Eigentum und alle Rechte, auch für Patenterteilung und Gebrauchsmusteranmeldung, vorbehalten. APV Rosista GmbH. Diese Zeichnung wurde mit CAD erstellt und darf nicht von Hand geändert werden.

Ersatzteilliste: spare parts list:
 Umschaltventil SWDPF43, SWDPF44-FS-CU und VSM
 Change over valve with steam barrier SWDPF43,
 SWDPF44-FS-CU and PSH DN25-100

Blatt 2



Gezeichnet 29.01.02
 Geprüft 06.03.02
 Name Trytko
 Name Spletthoff

Datum 01/02
 Name Trytko
 Datum 11/02
 Name Trytko
 Datum 04/04
 Name Trytko
 Datum 08/06
 Name Trytko
 Datum 08/07
 Name Trytko

RN 01.054.813

Pos. item	Benennung description	DN				WS-Nr. ref.-no.	WS-Nr. ref.-no.	WS-Nr. ref.-no.	WS-Nr. ref.-no.	WS-Nr. ref.-no.	WS-Nr. ref.-no.
		25	40	50	65						
1	Gehäuse Unterteil Housing lower part	15-60-290/47	15-60-390/47	15-60-440/47	15-60-490/47	15-60-540/47	15-60-640/47				
2	Gehäuse Oberteil Housing upper part	15-62-001/47	15-62-002/47	15-62-003/47	15-62-004/47	15-62-005/47	15-62-006/47				
2.1	Gehäuse Oberteil Housing upper part	15-63-001/47	15-63-002/47	15-63-003/47	15-63-004/47	15-63-005/47	15-63-006/47				
3	Tellerdichtung Seat seal	58-33-293/	58-33-393/	58-33-443/	58-33-493/	58-33-543/	58-33-643/				
4	Valv. Schaft Valve shaft	15-25-282/42	15-25-382/42	15-25-432/42	15-25-482/42	15-25-532/42	15-25-632/42				
5	Gehäusedichtung Housing seal	58-33-267/	58-33-292/	58-33-124/	58-33-442/	58-33-492/	58-33-127/				
6	Gelenkklemme Clamp	42-40-287/17	42-40-387/17	42-40-437/17	42-40-487/17	42-40-537/17	42-40-637/17				
7	Tellerdichtung Seat seal	58-33-293/	=	=	=	=	=				
8	Schaffdichtung Shaft seal	58-33-150/26	=	=	=	=	=				
9	O-Ring O-ring	58-06-078/64	=	=	=	=	=				
10	Führungsbuchse Bushing	08-01-178/23	=	=	=	=	=				
11	Laterne Yoke	15-40-973/47	15-40-974/47	15-40-975/47	15-40-976/47	15-40-979/47	15-40-956/47				
12	Skt. Schraube Hex. screw	DIN EN 24017-M8x16-A2-70									DIN EN 24017-M8x20-A2-70
13	Zugstange Guide rod	15-23-850/12	=	15-23-851/12	=	15-23-852/12	=				
14	Zentrierscheibe Centering washer	15-28-940/12	=	=	=	=	=				
15	Skt. Mutter Hex. nut	65-50-101/15	=	=	=	=	=				
16	Steuerkopf Actuator	15-32-050/17	=	15-32-051/17	=	15-32-052/17	=				
17	W-Verschraubung Angular union	08-60-750/93	=	=	=	=	=				
18	Control-Unit CU31 Control-Unit CU31	16-31-232/93	=	=	=	=	=				
19	Schaltmücke Operating cam	08-52-290/97	08-52-291/97	=	=	=	=				

Weitergabe sowie Vervielfältigung dieser Unterlage, Verwertung und Mitteilung ihres Inhalts nicht gestattet, soweit nicht schriftlich zugestanden. Verstoß verpflichtet zum Schadensersatz und kann strafrechtliche Folgen haben (Paragraf 18 UWG, Paragraf 106 UrtG). Eigentum und alle Rechte, auch für Patenterteilung und Gebrauchsmustererlangung, vorbehalten. APV Rosista GmbH. Diese Zeichnung wurde mit CAD erstellt und darf nicht von Hand geändert werden.

Ersatzteilliste: spare parts list:
 Umschaltventil SWDPF43, SWDPF44-FS-CU und VSM
 Change over valve with steam barrier SWDPF43,
 SWDPF44-FS-CU and PSH 1-4 Zoll

Besteht aus <u>3</u> Blatt		Blatt <u>1</u>	
Gezeichnet	29.01.02	Name	Trytko
Geprüft		Datum	
Normgepr.			
Datum <u>01/02</u>		Name <u>Trytko</u>	
RN 01.054.814			



APV Rosista GmbH
 D-59425 Urena
 Germany

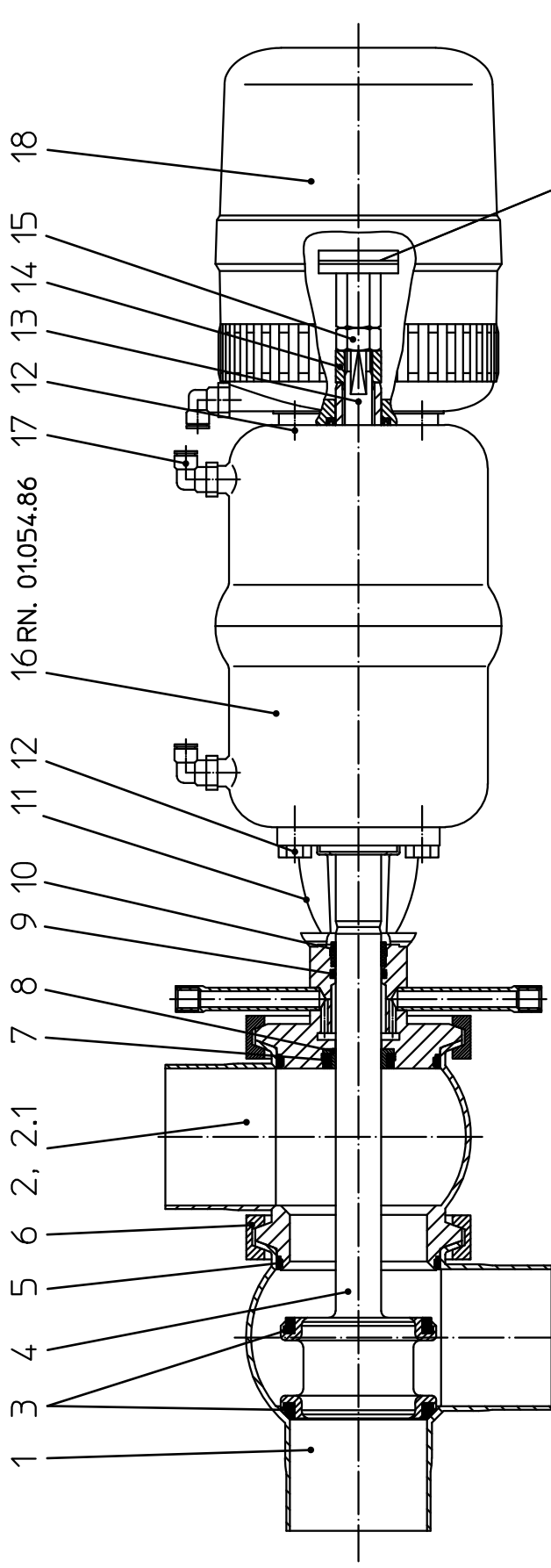

Schaltnocke
 actuator screw

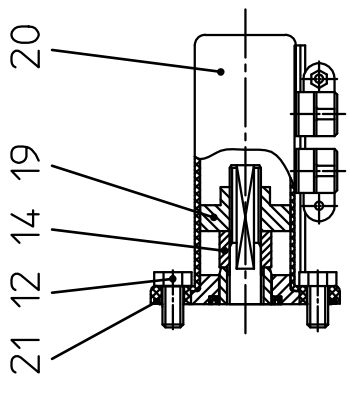

Es stehen verschiedene Dichtungswerkstoffe zur Verfügung. Bitte WS-Nr. ergänzen

The following seal materials are available (fill in last two digits of ref.-no.)

- * Dichtungswerkstoff: material seals:
- ../13-VMQ/Silicone
- ../33-HNBR
- ../73-FPM
- ../93-EPDM

Gehäusedichtung /housing seal
 Bei VMQ wird die HNBR-Gehäusedichtung eingesetzt.
 For VMQ take the HNBR-housing seal.

Weitergabe sowie Vervielfältigung dieser Unterlage, Verwertung und Mitteilung ihres Inhalts nicht gestattet, soweit nicht schriftlich zugestanden. Verstöß verpflichtet zum Schadensersatz und kann strafrechtliche Folgen haben (Paragraf 18 UWG, Paragraf 106 UWG). Eigentum und alle Rechte, auch für Patenterteilung und Gebrauchsmusteranmeldung, vorbehalten. APV Rosista GmbH. Diese Zeichnung wurde mit CAD erstellt und darf nicht von Hand geändert werden.



APV Rosista GmbH
D-58425 Urra
Germany

Gezeichnet		29.01.02		Trytko	
Geprüft		06.03.02		Spilithoff	
Normgepr.					

Blatt 3

Ersatzteilliste: spare parts list:
Umschaltventil SWDPF43, SWDPF44-FS-CU und VSM
Change over valve with steam barrier SWDPF43,
SWDPF44-FS-CU and PSH 1-4 Zoll

Datum	01/02	11/02	04/04
Name	Trytko	Trytko	Trytko

RN 01.054.814

Pos. item	Benennung description	1"		1,5"		2"		2,5"		3"		4"		
		WS-Nr. ref.-no.	WS-Nr. ref.-no.	WS-Nr. ref.-no.	WS-Nr. ref.-no.	WS-Nr. ref.-no.	WS-Nr. ref.-no.	WS-Nr. ref.-no.	WS-Nr. ref.-no.	WS-Nr. ref.-no.	WS-Nr. ref.-no.	WS-Nr. ref.-no.		
20	Ventilstellungsmeldung (VSM) SW4 Proximity switch holder (PSH) SW4	15-33-932/93	=	=	=	=	=	=	=	=	=	=	WS-Nr. ref.-no.	
21	O-Ring O-ring	OR 66x2 NBR 70 Shore A	66-2										WS-Nr. ref.-no.	
Pos. 3, 5, 7, 8, 9, 10 nur im kompletten Dichtungssatz erhältlich														
Item 3, 5, 7, 8, 9, 10 available es complete seal kits only														
1	Dichtungssatz Seal kit	58-34-822/00	58-34-823/00	58-34-824/00	58-34-830/00	58-34-831/00	58-34-827/00							
1	Dichtungssatz Seal kit	58-34-822/01	58-34-823/01	58-34-824/01	58-34-830/01	58-34-831/01	58-34-827/01							
1	Dichtungssatz Seal kit	58-34-822/02	58-34-823/02	58-34-824/02	58-34-830/02	58-34-831/02	58-34-827/02							
1	Dichtungssatz Seal kit	58-34-822/06	58-34-823/06	58-34-824/06	58-34-830/06	58-34-831/06	58-34-827/06							

Weitergabe sowie Vervielfältigung dieser Unterlage, Verwertung und Mitteilung ihres Inhalts nicht gestattet, soweit nicht schriftlich zugestanden. Verstößt verpflichtet zum Schadensersatz und kann strafrechtliche Folgen haben (Paragraf 18 UWG, Paragraf 106 UrhG). Eigentum und alle Rechte, auch für Patenterteilung und Gebrauchsmusteranmeldung, vorbehalten. APV Rosista GmbH. Diese Zeichnung wurde mit CAD erstellt und darf nicht von Hand geändert werden.

02/194

Ersatzteilliste: spare parts list:

Steuerkopf SW4

Actuator SW4

Besteht aus 1 Blatt Blatt 1

Datum	1/98	12/03	01/06	06/08
Name	Trytko	Trytko	Trytko	Trytko

Gezeichnet	15.1.98	Name	Trytko
Geprüft	15.1.98		
Normgepr.	19.1.98		



APV Rosista GmbH
D-58425 Unna
Germany

RN 01.054.86

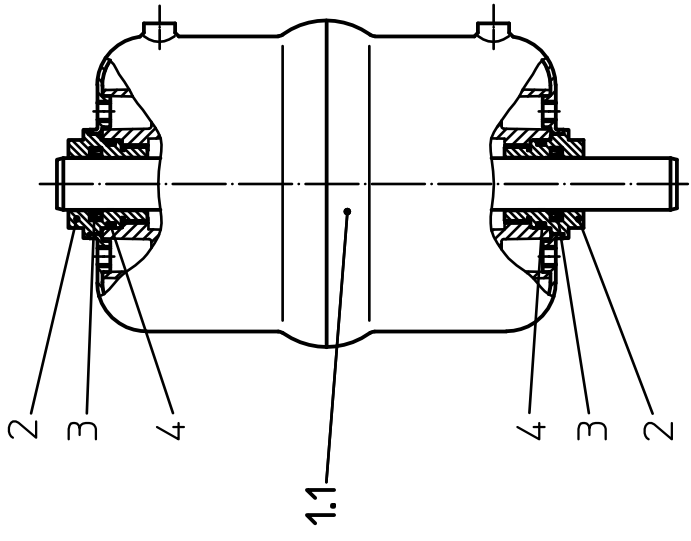
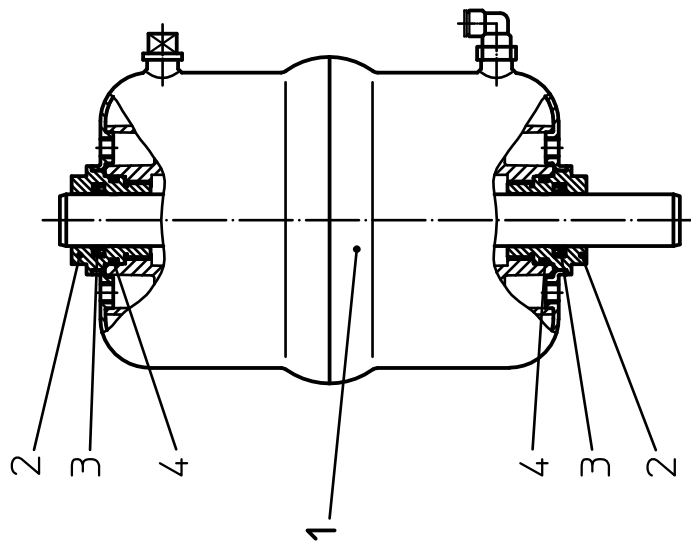

Pos. / Item	Quantität / Menge	Benennung / description	Ø74 WS-Nr. ref.-no.	Ø110 WS-Nr. ref.-no.	Ø165 WS-Nr. ref.-no.
1		Steuerkopf kpl Feder/Luft Ausf. matt-gl. Actuator complete spring/air design satin fin.	15-32-050/17	15-32-051/17	15-32-052/17
		Ausf. matt-gl. design satin fin.	15-32-085/17	15-32-086/17	15-32-087/17
1.1		Steuerkopf kpl Feder/Luft Ausf. 3A-blank Actuator complete spring/air design 3A-bright fin.	3A0 15-32-059/13	3A0 15-32-060/13	3A0 15-32-061/13
		Ausf. 3A-blank design 3A-bright fin.	3A0 15-32-057/13	3A0 15-32-065/13	3A0 15-32-066/13
2	2	Dichtungsschraube Seal screw	15-28-840/93	=	=
3	2	V-Dichtung V-seal	58-32-010/83	=	=
4	2	O-Ring O-ring	58-06-124/83	=	=